

\$899,000 - 1407 Borrego Pass, Santa Fe

MLS® #202504293

\$899,000

0 Bedroom, 0.00 Bathroom, 2,400 sqft
Residential on 1.58 Acres

N/A, Santa Fe, NM

Great business opportunity, 2 homes and an established dog boarding facility and business, also paddocks and stalls for horses, perfect for a vet rehab center! Approximately \$76,000 in income last year between the Dog Kennel and house rental, the horses are the owners but you could generate another \$30,000 if you rented out to 4 horses at \$600 a month.

Built in 1983

Listing Details

| | |
|----------------|---------------------------|
| Listing Agent | Virginia T. Henry |
| Listing Office | Santa Fe Bound RE Brokers |

Essential Information

| | |
|----------------|-----------------|
| MLS® # | 202504293 |
| Price | \$899,000 |
| Bathrooms | 0.00 |
| Square Footage | 2,400 |
| Square Footage | 2400 SquareFeet |
| Acres | 1.58 |
| Year Built | 1983 |
| Type | Residential |
| Sub-Type | Business |
| Style | Pueblo |
| Status | Active |

Community Information

| | |
|---------|-------------------|
| Address | 1407 Borrego Pass |
|---------|-------------------|



| | |
|-------------|----------------------|
| Area | 4N-SF City Limit SWN |
| Subdivision | N/A |
| City | Santa Fe |
| County | Santa Fe |
| State | NM |
| Zip Code | 87507 |

Amenities

| | |
|-----------|-------------------------------|
| Utilities | High Speed Internet Available |
| Parking | Attached, Garage, Carport, H |

Interior

| | |
|-------------------|-------------------------------|
| Interior | Wood |
| Interior Features | Beamed Ceilings, Interior Ste |
| Heating | Ductless, Fireplace(s) |
| Cooling | Ductless, Refrigerated |
| Has Basement | Yes |
| Basement | Crawl Space |

Exterior

| | |
|--------------|-------------------|
| Exterior | Frame |
| Windows | Insulated Windows |
| Roof | Flat, Tar/Gravel |
| Construction | Frame |

School Information

| | |
|------------|--------------------------|
| Elementary | Aspen Community Magnet S |
| Middle | Aspen Community Magnet S |
| High | Santa Fe |

Additional Information

| | |
|----------------|----------------------|
| Date Listed | September 18th, 2025 |
| Days on Market | 26 |
| Zoning | C-1 |

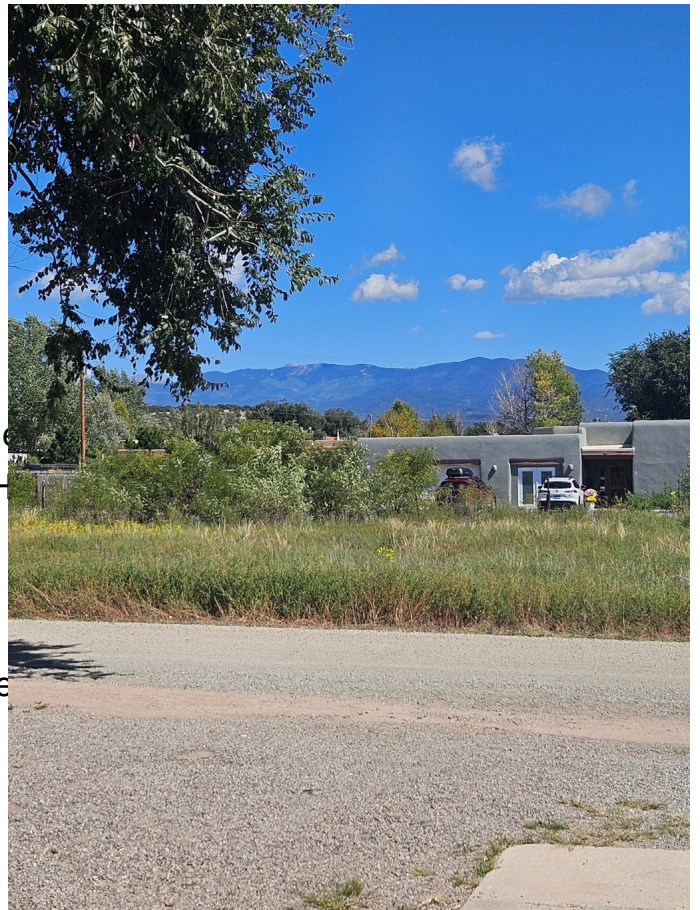

The data relating to real estate for sale in this Website comes in part from the Internet Data Exchange ("IDX") program of Santa Fe Association of REALTORS®, Inc. from a copyrighted compilation of listings. Real estate listings held by brokers other than NM home Team Realty are marked with the IDX Logo. All data in this Website is deemed reliable but is not guaranteed accurate, and should be independently verified. The information provided is for consumers' personal, non-commercial use and may not be used for any purpose other than to identify

prospective properties consumers may be interested in purchasing. All properties are subject to prior sale or withdrawal. All Rights Reserved.